

Tennis Court Broom D-Handle Assembly Instructions:

Included in the box:

ITEM NO.	DESCRIPTION	QTY.
1	10GA STAINLESS SELF TAPPING SCREW	8
2	ALUMINIUM BRUSH BACK	1
3	BRUSH	1
4	DHANDLE	1
5	HANDLE JOINER	2
6	HANDLE STAYS	2
7	M6 STAINLESS BUTTON HEAD	4
8	HANDLE BRACKET	2
9	M6 STAINLESS NYLOC NUT	4
10	M6 STAINLESS SOCKET HEAD CAP SCREW	4
11	M6 STAINLESS WASHER	8
12	ALLEN KEY	1

(Other Tools needed: Phillips Head Screwdriver, 5mm Allen Key, 10mm Spanner/Socket)

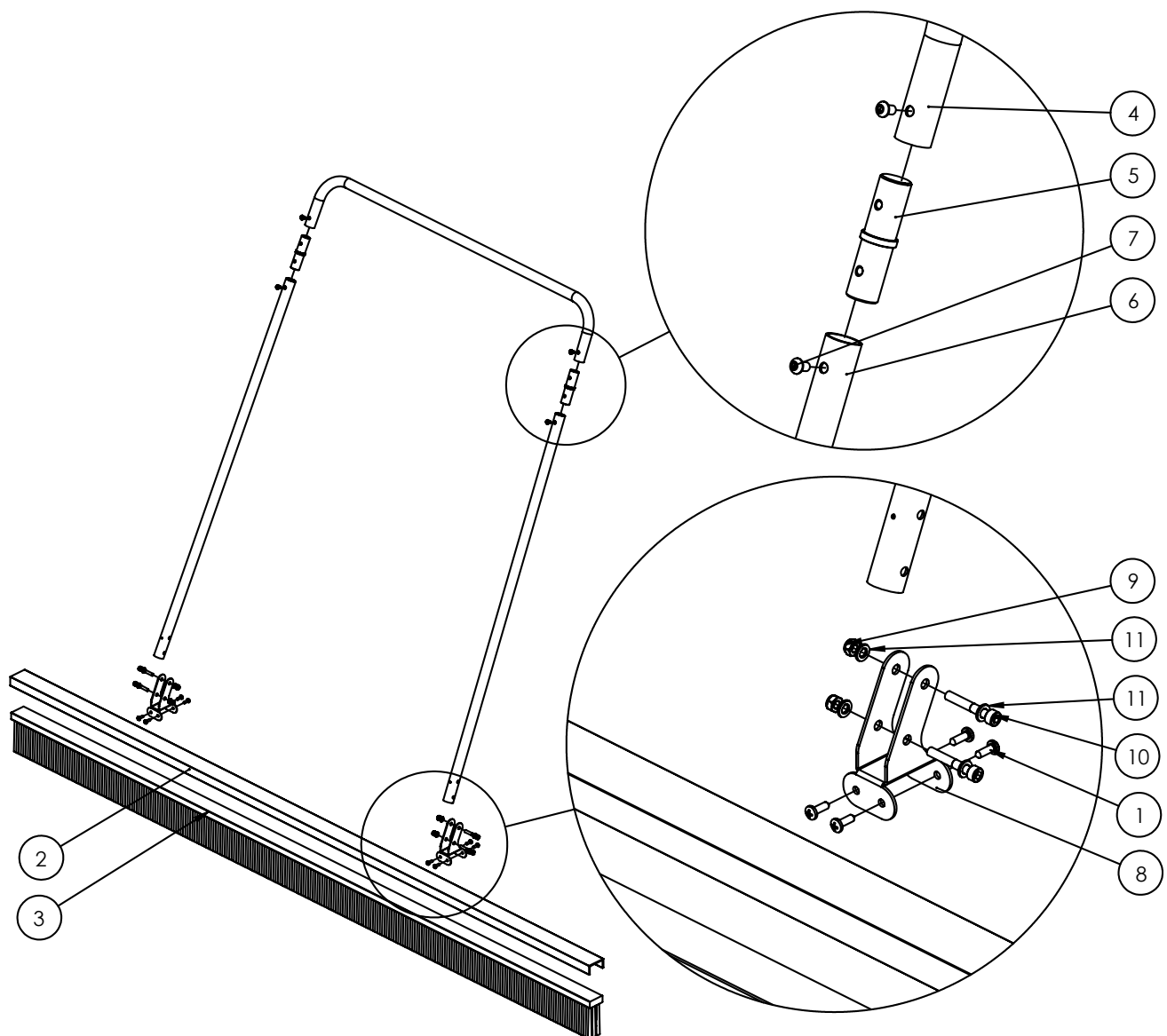

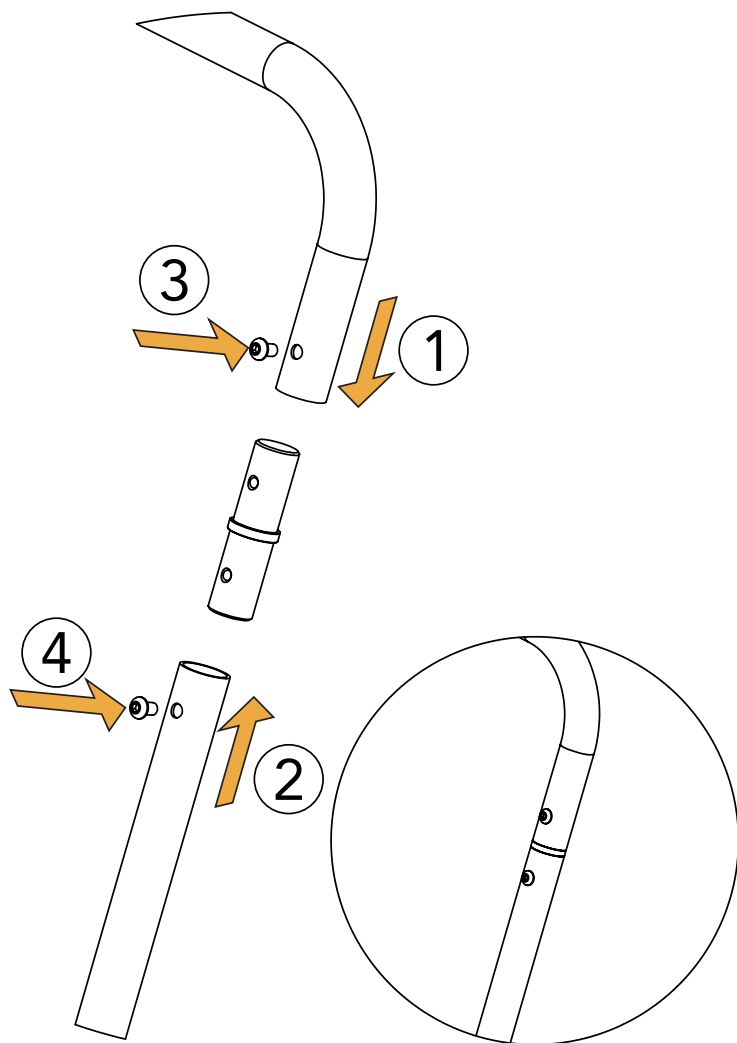

1. Install the DHANDLE onto the HANDLE JOINER, ensure the hole in the DHANDLE lines up with the hole in the HANDLE JOINER

2. Install the HANDLE STAY onto the HANDLE JOINER, ensure the hole in the HANDLE STAY lines up with the hole in the HANDLE JOINER.

3. Install the small M6 STAINLESS BUTTON HEAD through the hole in the DHANDLE and tighten with the provided 4mm ALLEN KEY. **DO NOT OVER TIGHTEN**

4. Install the small M6 STAINLESS BUTTON HEAD through the hole in the HANDLE STAY and tighten with the provided ALLEN KEY. **DO NOT OVER TIGHTEN**

Repeat steps 1-4 for the other side of the handle assembly.

5. Slide the bottom of the HANDLE STAY into the HANDLE BRACKET.

6. Place a M6 STAINLESS WASHER onto 2 of the M6 STAINLESS SOCKET HEAD CAP SCREWS and install through the 2 Holes on the HANDLE BRACKET, through the HANDLE STAY and back out the other side of the HANDLE BRACKET.

7. Install another 2 M6 STAINLESS WASHERS and M6 STAINLESS NYLOC NUTS onto the M6 STAINLESS SOCKET HEAD CAP SCREWS. Tighten with the ALLEN KEY provided and a small spanner. **TIGHTEN UNTILL THE HANDLE BRACKET BEGINS TO CLAP THE HANDLE STAY, DO NOT DEFORM THE HANDLE STAY.**

Repeat steps 5-7 for the other side of the handle assembly.

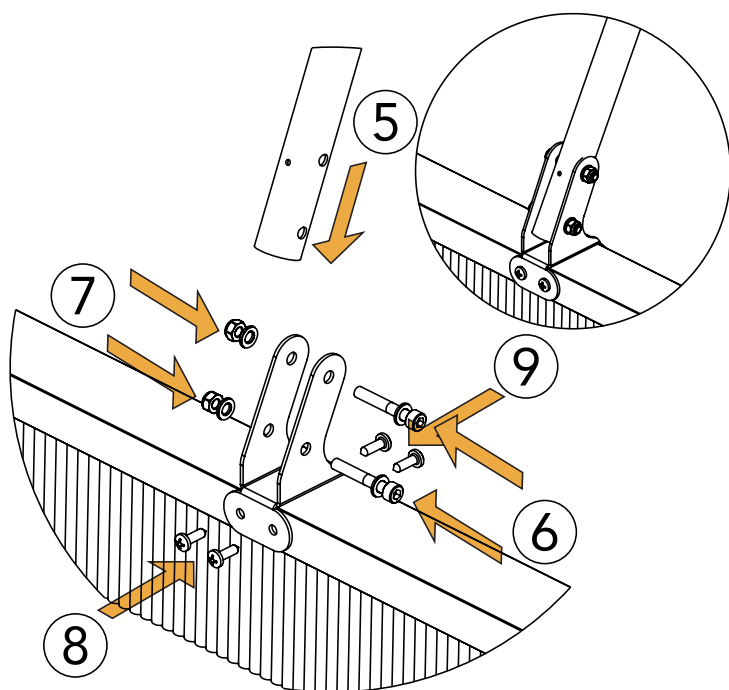

8. If your broom did not come with the HANDLE BRACKETS installed, Place the ALUMINIUM BRUSH BACK, and position them so they measure 480mm from each end. Install each HANDLE BRACKET using 4 x 10GA STAINLESS SELF TAPPING SCREWS. **A SMALL 3mm PILOT HOLE CAN BE DRILLED TO MAKE INSTALLING THE SCREWS EASIER**